



US Army Corps
of Engineers
Memphis District

Public Notice

FILE NUMBER: MVM-2017-305 (JKB)

NOTICE DATE:
September 29, 2017

Attn: Postmaster,
Please Post Until

EXPIRATION DATE:
⇒ October 30, 2017

Joint Public Notice

U.S. Army Corps of Engineers and State of Arkansas

AUTHORITY: Pursuant to 33 CFR 325, as published in the Federal Register dated November 13, 1986, this notice announces an application submitted for an after-the-fact Department of the Army permit under Section 404 of the Clean Water Act.

APPLICANT:

Randy Ferguson
Sub-District No.1 Carson Lake Drainage District No. 8
P.O. Box 122
Osceola, Arkansas 72370
(870) 563-6518

PURPOSE: According to the applicant, the purpose of the project is to alleviate flooding around Wilson, Arkansas.

LOCATION: The project site is located in Section 8, Township 11N, Range 10E, in Mississippi County, Arkansas, at approximate Latitude 35.58716°N and Longitude -90.04663°W on the Wilson 7.5 minute quadrangle map (Attachment 1).

DESCRIPTION OF WORK: The applicant has placed a 70-foot long by 4.5-foot pipe in Ditch No. 26. The pipe has a flap gate where Ditch No. 26 empties into Ditch No. 9 (Attachment 2). The flap gate is currently open and not being utilized by the applicant. The location of the pipe and flap gate is at the convergence of Ditch No. 9, Ditch No. 19, and Ditch No. 26. According to the applicant, Ditch No. 9 has a drainage area of 11,212 acres and Ditch No. 19 has a drainage area of 12,180 acres. Ditch No. 26 has a drainage area of 1,247 acres (Attachments 3 and 4). The applicant proposes to permanently close the flap gate on the existing pipe to prevent water from Ditch No. 9 and Ditch No. 19 from flowing back into Ditch No. 26 and causing flooding around Wilson. The flap gate would allow water in Ditch No. 26 to continue to empty into Ditch No. 9.

AVOIDANCE/MINIMIZATION: According to the applicant, the pipe installed was the minimum length for safe crossing of Ditch No. 26 with modern farming equipment.

WATER QUALITY CERTIFICATION: By copy of this public notice, the applicant is requesting water quality certification from the Arkansas Department of Environmental Quality that the activity will comply with applicable requirements set forth in 33 U.S.C. and 1341 (a) (1) of the Clean Water Act and all State laws and regulations promulgated pursuant thereto. This certification or evidence of the water quality certification or waiver of the right to certify must be submitted prior to the issuance of a Corps of Engineers permit. The Corps of Engineers evaluation of the impact of the activity on the public interest will include application of the guidelines promulgated by the Administrator, EPA, under authority of Section 404(b) of the Clean Water Act.

ENDANGERED SPECIES: Our preliminary determination is that there would be no endangered species or critical habitat affected by this proposal. However, this notice is being coordinated with the U.S. Fish and Wildlife Service (USFWS). Any comments USFWS may have regarding endangered or threatened wildlife or plants or their critical habitat, will be considered in our evaluation of the described work.

CULTURAL RESOURCES: A review of the National Register of Historic Places indicated no known resources within the project area. However, the Memphis District will evaluate information provided by the State Historic Preservation Officer, federally recognized Tribes, and the public in response to this public notice and we may require a survey of the project area.

FLOODPLAIN: In accordance with 44 CFR Part 60 (Floodplain Management and Use), participating communities are required to review all proposed development to determine if a floodplain development permit is required. Floodplain administrators should review the proposed public notice and notify this office of any floodplain development permit requirements.

PUBLIC INTEREST REVIEW: The purpose of this public notice is to advise all interested parties of the activities for which a permit is sought and to solicit comments and information necessary to evaluate the probable impact on the public interest.

The decision whether to issue a permit will be based on an evaluation of the probable impact including cumulative impacts of the activity on the public interest. That decision will reflect the national concern for both protection and utilization of important resources. The benefits, which reasonably may be expected to accrue from the project, must be balanced against its reasonably foreseeable detriments. All factors which may be relevant to the project will be considered, including the cumulative effects thereof; among those are conservation, economics, aesthetics, general environmental concerns, wetlands, historic properties, fish and wildlife values, flood hazards, floodplain values, land use, navigation, shoreline erosion and accretion, recreation, water supply and conservation, water quality, energy needs, safety, food and fiber production, mineral needs, considerations of property ownership and in general, the needs and welfare of the people.

The Corps of Engineers is soliciting comments from the public; federal, state and local agencies and officials; federally recognized Tribes; and other interested parties in order to consider and evaluate the impacts of this proposed activity. Any comments received will be considered by the Corps of Engineers to determine whether to issue, modify, condition or deny a permit for this proposal. To make this decision, comments are used to assess impacts on endangered species, historic properties, water quality, general environmental effects and the other public interest factors listed above. Comments are used in the preparation of an Environmental Assessment and/or an Environmental Impact Statement pursuant to the National Environmental Policy Act. Comments are also used to determine the need for a public hearing and to determine the overall public interest of the proposed activity.

PUBLIC HEARING: Any person may request, in writing, within the comment period specified in this notice that a public hearing be held to consider this application. Requests for a public hearing shall state, with particularity, the reason for holding a public hearing. The District Engineer will determine if the issues raised are substantial and whether a hearing is needed for making a decision. If a public hearing is held, it will be for the purpose of obtaining additional information that we could not otherwise obtain through a public notice process; not to inform the public about the specific details of the project in greater detail than what is found in this notice. This is not a Corps of Engineers project. We are not a proponent nor are we an opponent of the project. We are merely the permitting authority of Section 404 and Section 10 permits required by our office.

COMMENTS OR REQUEST FOR ADDITIONAL INFORMATION: Send comments to the Corps of Engineers, Memphis District and Arkansas Department of Environmental Quality. Comments may be sent via mail or E-mail to the following:

U.S. Army Corps of Engineers – Memphis District
ATTN: Josh Bright
167 North Main Street, Room B-202
Memphis, Tennessee 38103-1894
E-mail: joshua.k.bright@usace.army.mil
phone: (901) 544-0926
fax: (901) 544-0211

State Permits Branch, Water Division
Arkansas Department of Environmental Quality
ATTN: Lazendra Hairston
5301 North Shore Drive
Little Rock, Arkansas 72118-5317
E-mail: hairstonl@adeq.state.ar.us

The Corps of Engineers may provide copies of all comments, (including name & address of those providing comments) to the applicant for consideration and response prior to a decision. Comments must be received by the expiration date listed on page one of this notice.

For Final Individual Permits actions in the Memphis District, go to the following link: <http://geo.usace.army.mil/egis/f?p=340:2:0::NO:RP>. Using the Filter by District drop down box, select MVM-Memphis District, then select the year and month (information will populate in the table below). All pending individual permits can be located by selecting the “**Pending IP**” tab above. All of the environmental documents and statements of findings supporting issuance or denial of the permit decisions are available upon written request and where applicable, upon the payment of administrative fees. They are also available at the Memphis District, Regulatory Branch office for examination.

Gregg W. Williams
Chief
Regulatory Branch

Attachments

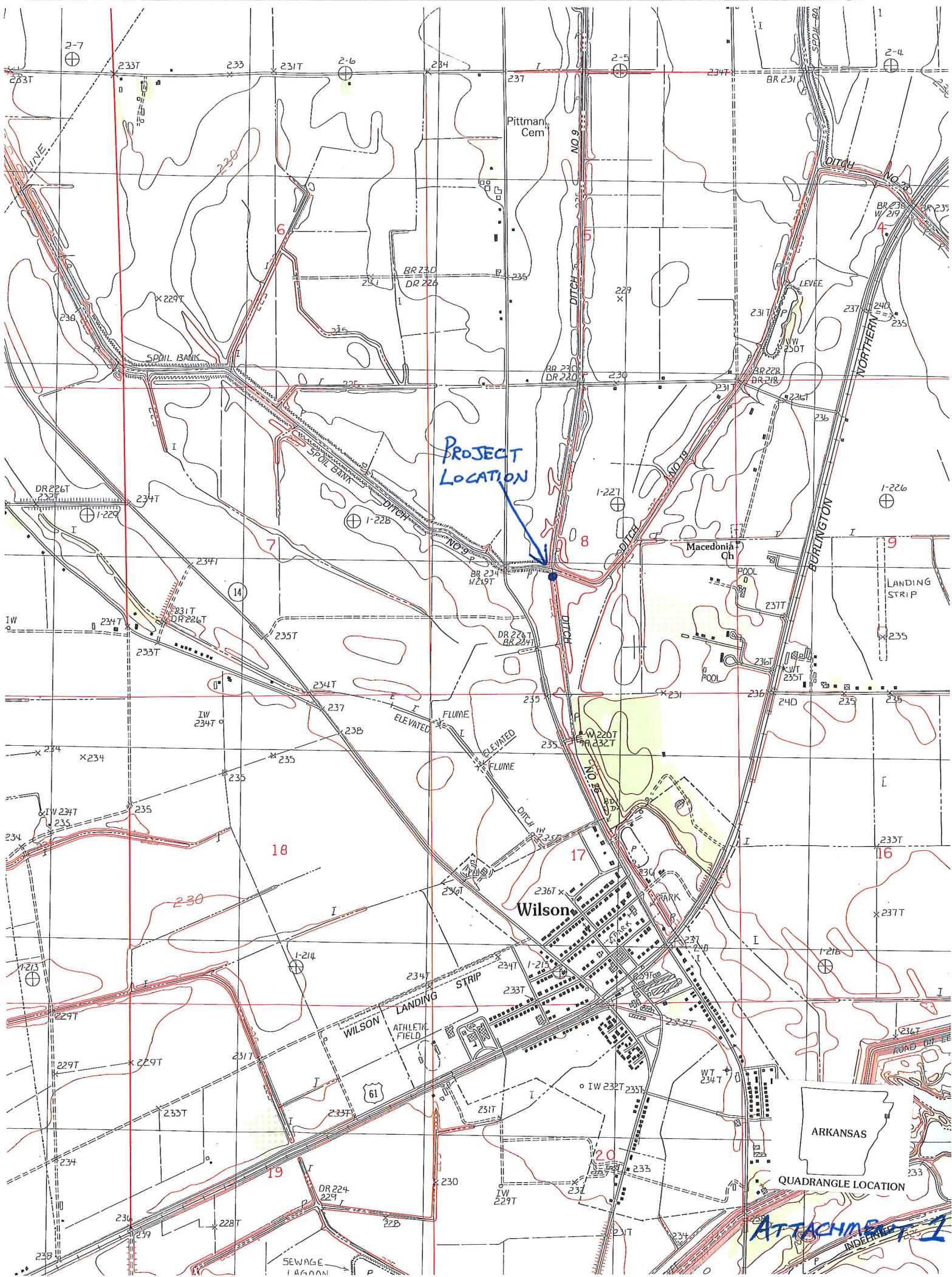

PROJECT
LOCATION

Wilson

ARKANSAS

QUADRANGLE LOCATION

ATTACHMENT 1

Pittman Cem

Macedonia Ch

WILSON LANDING STRIP

ATHLETIC FIELD

61

SEWAGE LAGOON

DITCH

LEVEE

DITCH

DITCH

DITCH

DITCH

DITCH

DITCH

DITCH

DITCH

NO 9

NO 10

NO 11

NO 12

NO 13

NO 14

NO 15

NO 16

BR 231

BR 232

BR 233

BR 234

BR 235

BR 236

BR 237

BR 238

BR 239

BR 240

BR 230

BR 231

BR 232

BR 233

BR 234

BR 235

BR 236

BR 237

BR 238

X 229T

X 230T

X 231T

X 232T

X 233T

X 234T

X 235T

X 236T

X 237T

X 229T

X 230T

X 231T

X 232T

X 233T

X 234T

X 235T

X 236T

X 237T

X 229T

X 230T

X 231T

X 232T

X 233T

X 234T

X 235T

X 236T

X 237T

X 229T

X 230T

X 231T

X 232T

X 233T

X 234T

X 235T

X 236T

X 237T

BR 231

BR 232

BR 233

BR 234

BR 235

BR 236

BR 237

BR 238

BR 239

BR 240

BR 230

BR 231

BR 232

BR 233

BR 234

BR 235

BR 236

BR 237

BR 238

X 229T

X 230T

X 231T

X 232T

X 233T

X 234T

X 235T

X 236T

X 237T

X 229T

X 230T

X 231T

X 232T

X 233T

X 234T

X 235T

X 236T

X 237T

X 229T

X 230T

X 231T

X 232T

X 233T

X 234T

X 235T

X 236T

X 237T

X 229T

X 230T

X 231T

X 232T

X 233T

X 234T

X 235T

X 236T

X 237T

BR 231

BR 232

BR 233

BR 234

BR 235

BR 236

BR 237

BR 238

BR 239

BR 240

BR 230

BR 231

BR 232

BR 233

BR 234

BR 235

BR 236

BR 237

BR 238

X 229T

X 230T

X 231T

X 232T

X 233T

X 234T

X 235T

X 236T

X 237T

X 229T

X 230T

X 231T

X 232T

X 233T

X 234T

X 235T

X 236T

X 237T

X 229T

X 230T

X 231T

X 232T

X 233T

X 234T

X 235T

X 236T

X 237T

X 229T

X 230T

X 231T

X 232T

X 233T

X 234T

X 235T

X 236T

X 237T

BR 231

BR 232

BR 233

BR 234

BR 235

BR 236

BR 237

BR 238

BR 239

BR 240

BR 230

BR 231

BR 232

BR 233

BR 234

BR 235

BR 236

BR 237

BR 238

X 229T

X 230T

X 231T

X 232T

X 233T

X 234T

X 235T

X 236T

X 237T

X 229T

X 230T

X 231T

X 232T

X 233T

X 234T

X 235T

X 236T

X 237T

X 229T

X 230T

X 231T

X 232T

X 233T

X 234T

X 235T

X 236T

X 237T

X 229T

X 230T

X 231T

X 232T

X 233T

X 234T

X 235T

X 236T

X 237T

BR 231

BR 232

BR 233

BR 234

BR 235

BR 236

BR 237

BR 238

BR 239

BR 240

BR 230

BR 231

BR 232

BR 233

BR 234

BR 235

BR 236

BR 237

BR 238

X 229T

X 230T

X 231T

X 232T

X 233T

X 234T

X 235T

X 236T

X 237T

X 229T

X 230T

X 231T

X 232T

X 233T

X 234T

X 235T

X 236T

X 237T

X 229T

X 230T

X 231T

X 232T

X 233T

X 234T

X 235T

X 236T

X 237T

X 229T

X 230T

X 231T

X 232T

X 233T

X 234T

X 235T

X 236T

X 237T

BR 231

BR 232

BR 233

BR 234

BR 235

BR 236

BR 237

BR 238

BR 239

BR 240

BR 230

BR 231

BR 232

BR 233

BR 234

BR 235

ArcGIS > Pipe Location Ditch 26

New

- Details
- Add
- Edit
- Basemap
- Save
- Share
- Print
- Measure
- Bookmarks
- 72395



ATTACHMENT 2

Drainage Ditches 9, 19 & 26 Drainage Areas

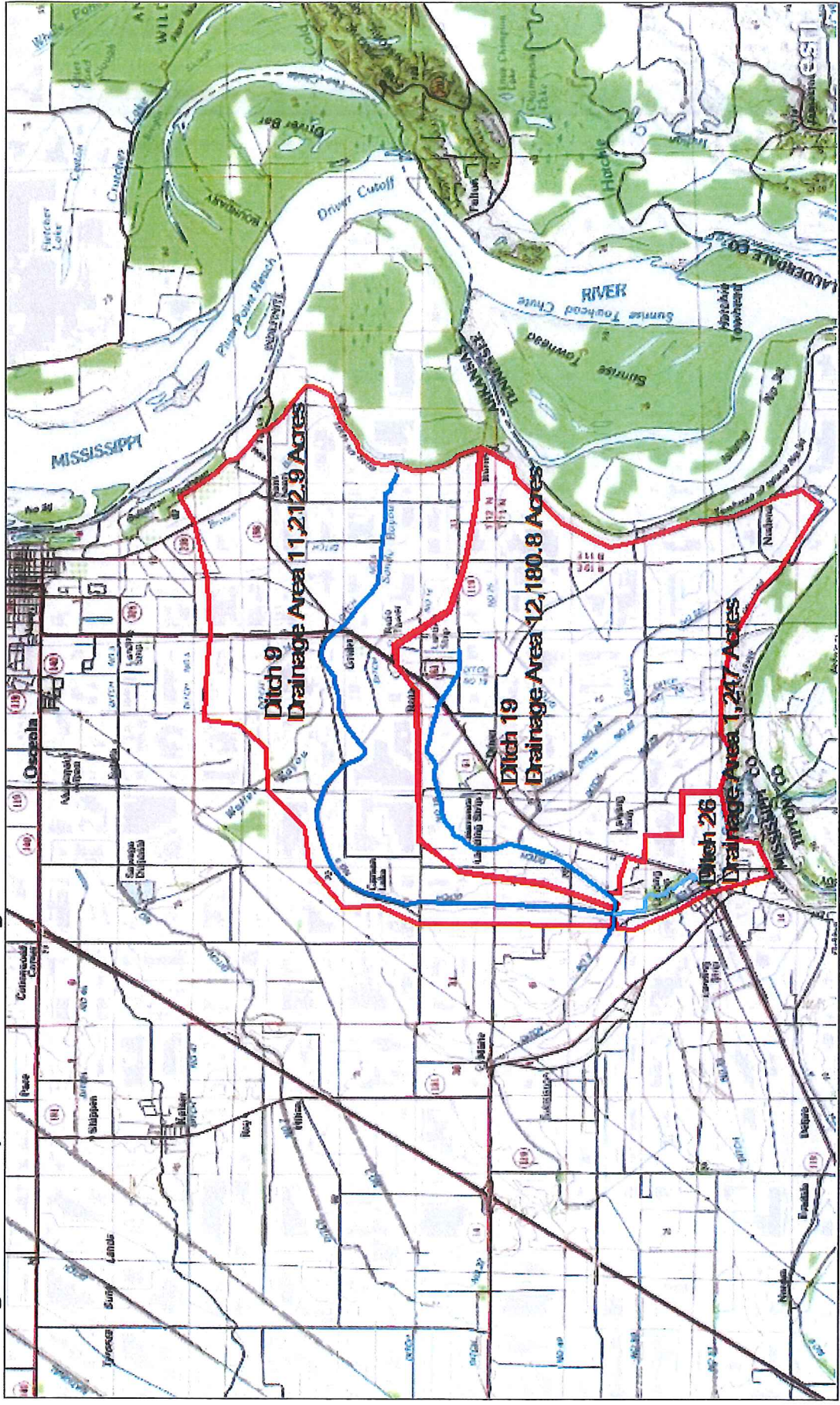

Copyright: © 2013 National Geographic Society, i-cubed

Legend

E Co Rd 956



2000 ft

DITCH 19

PIPE
w/ FLAP
GATE

DITCH 26

S Co Rd 447

DITCH 9

DITCH 9

E Co Rd 912

NORMAL
FLOW



Google earth

© 2017 Google

ATTACHMENT 4