

US Army Corps
of Engineers
Memphis District

Public Notice

FILE NUMBER: MVM 2018-275

NOTICE DATE:
September 6, 2018

Attn: Postmaster,
Please Post Until

EXPIRATION DATE:
October 9, 2018



Public Notice

U.S. Army Corps of Engineers

AUTHORITY: Pursuant to 33 CFR 325, as published in the Federal Register dated November 13, 1986, this notice announces an application submitted for a Department of the Army permit under Section 10 of the Rivers and Harbors Act.

APPLICANT:

Steve McCrackin
Bunge North America
1391 Timberlake Manor Pkwy
Chesterfield, MO 63017

AGENT:

Beau Rothwell
Ambitech Engineering
11885 Lackland Road
Maryland Height, MO 63146

PURPOSE: The project purpose is to construct a new work barge and conveyor system to replace the already existing structure which has reached the end of its serviceable life.

LOCATION: The project site is located along the western (right descending) bank of the Mississippi River at River Mile 783 in Osceola, Mississippi County, Arkansas, as shown on the attached map (Sheet 1). The approximate latitude and longitude for the project are 35.656471° and -89.927923°.

DESCRIPTION OF WORK: Bunge North America is proposing to replace a barge loading conveyor and associated structures at the riverside loading facility along the Mississippi River located in Osceola, Arkansas. The existing barge loading conveyor and supporting structures were installed around 1963 and are near the end of their useful life. Two (2) existing conveyors, one (1) 151 feet in length and one (1) 207 feet in length, will be replaced with new conveyors. The conveyors will be supported by two (2) support trusses of roughly equivalent length and a support tower with foundations. A new loading spout will be added to the conveyor to unload barges. A new work barge, ranging in size from 300 feet in length and 55 feet in width, to 200 feet in length and 35 feet in width, will be added to the site supported by six (6) new river dolphins. Each dolphin will measure 6-7 feet in diameter, 125 feet in height, and will be driven 40 feet deep into the river bottom for structural stability (Sheets 2-3).

ENDANGERED SPECIES: The interior least tern (*Sterna antillarum athalassos*), piping plover (*Charadrius melodus*), bald eagle (*Haliaeetus leucocephalus*), Indiana bat (*Myotis sodalis*), northern long-eared bat (*Myotis septentrionalis*), pallid sturgeon (*Scaphirhynchus albus*), and fat pocketbook mussel (*Potamilus capax*) are listed as threatened or endangered by U.S. Fish and Wildlife Service (USFWS) in Mississippi County, Arkansas. This application is being coordinated with USFWS. Any comments they may have regarding endangered or threatened wildlife or plants, or their critical habitat, will be considered in our evaluation of the described work.

CULTURAL RESOURCES: The Memphis District has not completed our analysis of the proposed undertaking and therefore has not reached a final project determination. All information provided by the State Historic Preservation Officer, federally-recognized Tribes, and the public in response to this public notice will be evaluated.

FLOODPLAIN: In accordance with 44 CFR Part 60 (Floodplain Management and Use), participating communities are required to review all proposed development to determine if a floodplain development permit is required. Floodplain administrators should review the proposed public notice and notify this office of any floodplain development permit requirements.

PUBLIC INTEREST REVIEW: The purpose of this public notice is to advise all interested parties of the activities for which a permit is sought and to solicit comments and information necessary to evaluate the probable impact on the public interest.

The decision whether to issue a permit will be based on an evaluation of the probable impact including cumulative impacts of the activity on the public interest. That decision will reflect the national concern for both protection and utilization of important resources. The benefits which reasonably may be expected to accrue from the project must be balanced against its reasonably foreseeable detriments. All factors which may be relevant to the project will be considered, including the cumulative effects thereof; among those are conservation, economics, aesthetics, general environmental concerns, wetlands, historic properties, fish and wildlife values, flood hazards, floodplain values, land use, navigation, shoreline erosion and accretion, recreation, water supply and conservation, water quality, energy needs, safety, food and fiber production, mineral needs, considerations of property ownership, and in general, the needs and welfare of the people.

The Corps of Engineers is soliciting comments from the public; federal, state, and local agencies and officials; federally recognized Tribes; and other interested parties in order to consider and evaluate the impacts of this proposed activity. Any comments received will be considered by the Corps of Engineers to determine whether to issue, modify, condition or deny a permit for this proposal. To make this decision, comments are used to assess impacts on endangered species, historic properties, water quality, general environmental effects, and the other public interest factors listed above. Comments are used in the preparation of an Environmental Assessment and/or an Environmental Impact Statement pursuant to the National Environmental Policy Act. Comments are also used to determine the need for a public hearing and to determine the overall public interest of the proposed activity.

PUBLIC HEARING: Any person may request, in writing, within the comment period specified in this notice that a public hearing be held to consider this application. Requests for a public hearing shall state, with particularity, the reason for holding a public hearing. The District Engineer will determine if the issues raised are substantial and whether a hearing is needed for making a decision. If a public hearing is held, it will be for the purpose of obtaining additional information that we could not otherwise obtain through a public notice process; not to inform the public about the specific details of the project in greater detail than what is found in this notice. This is not a Corps of Engineers project. We are not a proponent nor are we an opponent of the project. We are merely the permitting authority of Section 10 permits required by our office.

COMMENTS: To request additional information or provide comments on this notice, please contact Mr. Charles Keating using the information below:

U.S. Army Corps of Engineers - Memphis District
ATTN: Charles D. Keating
167 N. Main Street, B-202
Memphis, Tennessee 38103-1894
e-mail: charles.d.keating@usace.army.mil
phone: (901) 544-0733
fax: (901) 544-0211

Comments may be sent via mail or email. The Corps of Engineers may provide copies of all comments, (including name & address of those providing comments) to the applicant for consideration and response prior to a decision. Comments must be received by the expiration date listed on page one of this notice.

For Final Individual Permits actions in the Memphis District, go to the following link: <http://geo.usace.army.mil/egis/f?p=340:2:0::NO:RP>. Using the Filter by District drop down box, select MVM-Memphis District, then select the year and month (information will populate in the table below). All pending individual permits can be located by selecting the “**Pending IP**” tab above. All of the environmental documents and statements of findings supporting issuance or denial of the permit decisions are available upon written request and where applicable, upon the payment of administrative fees. They are also available at the Memphis District, Regulatory Branch office for examination.

Gregg Williams
Chief
Regulatory Branch

Attachments

BUNGE NORTH AMERICA

CORPS PERMIT

Mississippi County, Arkansas

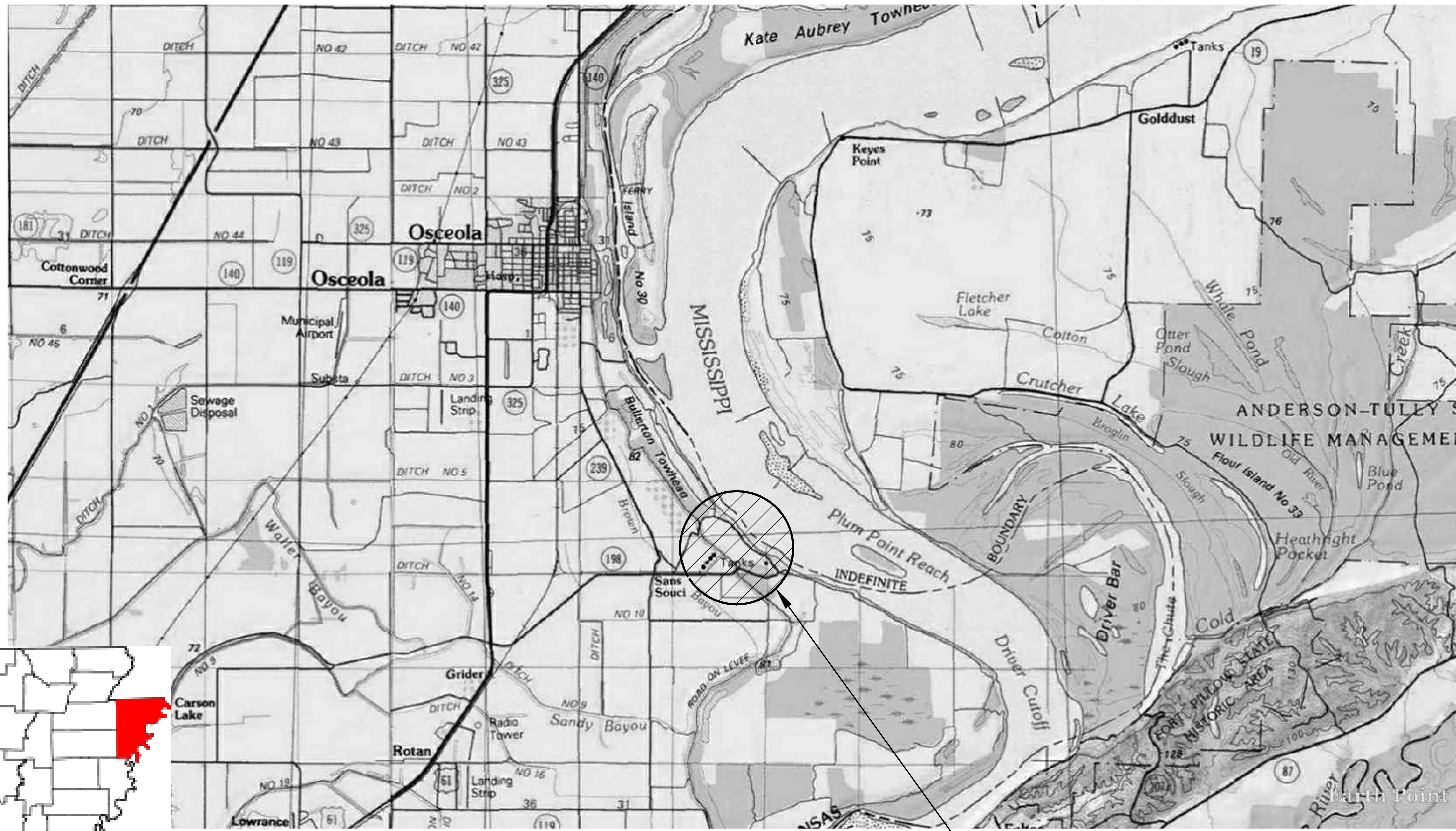
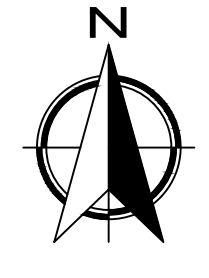

PROJECT
LOCATION

VICINITY MAP

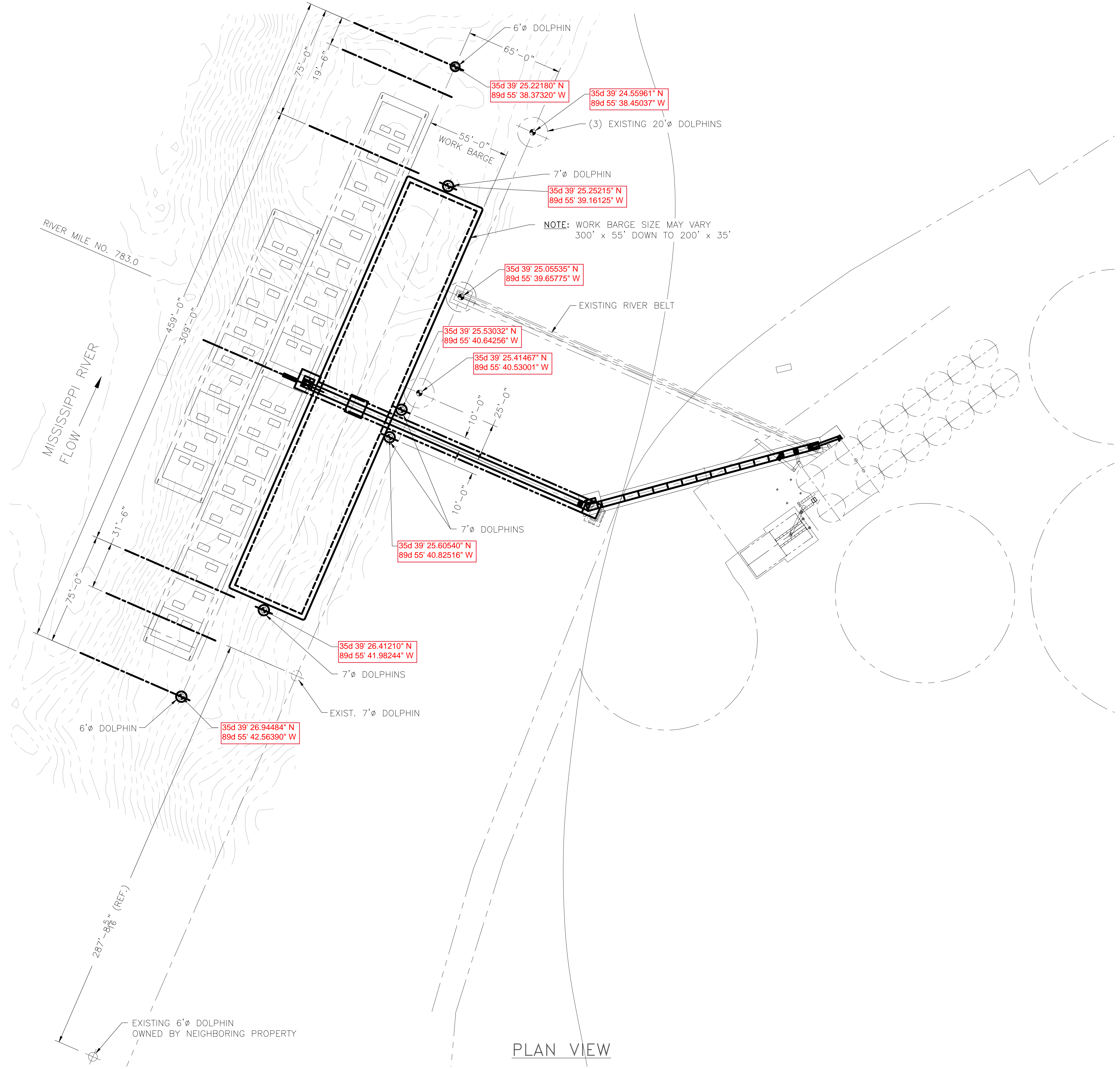

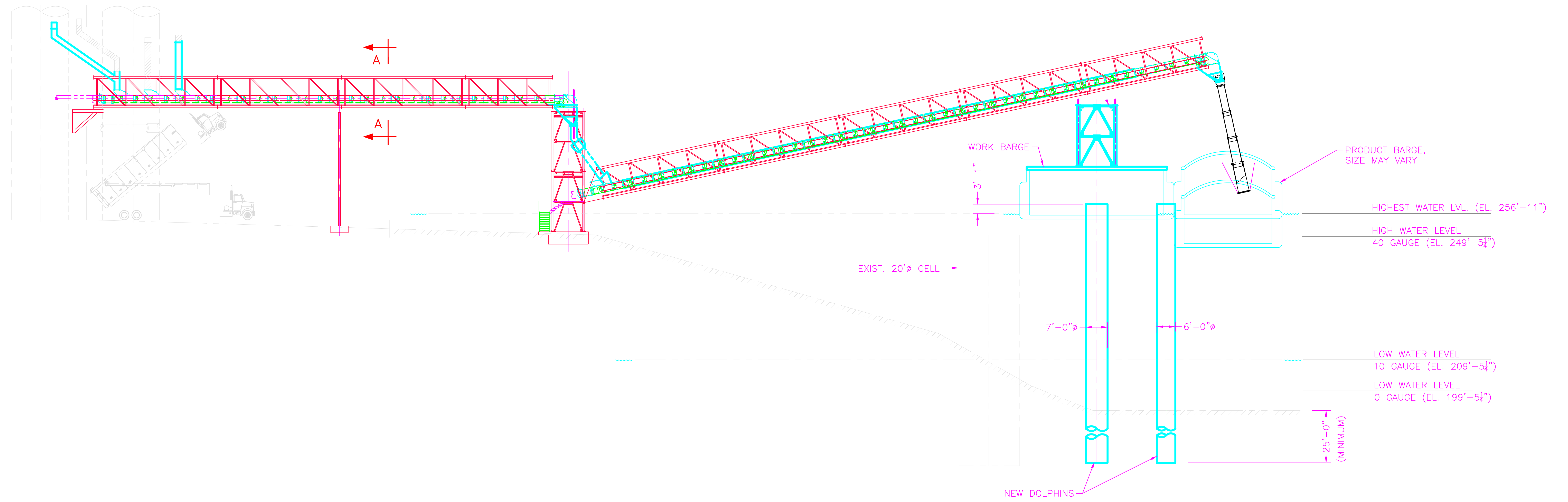

HIGH WATER ELEVATION VIEW (LOOKING WEST)